



Lexington-Fayette Urban County Government
DEPARTMENT OF ENVIRONMENTAL QUALITY & PUBLIC WORKS

Jim Gray
Mayor

Dowell Hoskins-Squier, P.E.
Commissioner

January 27, 2016

Mentelle Neighborhood :

The following petition is provided for requesting the Division of Traffic Engineering to change Hambrick Avenue from a One-Way street back to a Two-Way street. The petition area includes all properties in the neighborhood bounded by Walton Ave. and N Ashland Ave. (see enclosed exhibit as a reference). A total of 12 signatures out of 18 are needed to meet the 65% threshold in order to proceed with the study. **Only one signature can be applied to each property parcel.**

Once a successful petition is produced, then the Division of Traffic Engineering will proceed to schedule the street for data collection. The data will then be processed and checked against criteria. The criteria used by the Division of Traffic Engineering are provided in the *Neighborhood Traffic Management Manual*. A copy of the manual is included.

Please return the petition after it is completed to the following address:

Division of Traffic Engineering
101 E. Vine Street, Suite 300
Lexington, KY 40507-1470

Please look over this information and share it with your neighbors; feel free to call myself should you have questions.

Sincerely,

George M. Thornsby, P.E.
Traffic Engineer
Division of Traffic Engineering
(859) 258-3830 Fax: (859) 425-2054

GMT/dbt

cc: Jake Gibbs, 3rd District Councilmember
Dowell Hoskins-Squier, P.E., Commissioner of Environmental Quality & Public Works
Jeffrey Neal, P.E., Acting Director of Traffic Engineering
Jim Woods, P.E., P.L.S., Deputy Director of Traffic Engineering
Roger T. Mulvaney, P.E., Traffic Engineer Manager
Sally Warfield, Legislative Aide to CM Gibbs

NTMP PETITION FORM

We the undersigned, as residents of Hambrick Ave. hereby request the evaluation of the traffic problem(s) being identified as _____.

We petition the LFUCG to begin the development of a Neighborhood Traffic Management project.

We understand that the LFUCG will, upon receipt of a petition that demonstrates the support of 65% of property owners/residents, analyze relevant conditions to determine the impact of the proposed action. The LFUCG must reserve the right to overrule the petition if there are extenuating circumstances detrimental to public safety, traffic operations, and/or neighborhood interests.

Please list all addresses in the petition area. One signature per property parcel permitted.

DATE	NAME (PLEASE PRINT)	ADDRESS	SIGNATURE
		700 HAMBRICK AVE	
		703 HAMBRICK AVE	
		705 HAMBRICK AVE	
		706 HAMBRICK AVE	
		709 HAMBRICK AVE	
		710 HAMBRICK AVE	
		711 HAMBRICK AVE	
		714 HAMBRICK AVE	
		717 HAMBRICK AVE	
		718 HAMBRICK AVE	
		722 HAMBRICK AVE	
		723 HAMBRICK AVE	
		724 HAMBRICK AVE	
		726 HAMBRICK AVE	
		727 HAMBRICK AVE	
		729 HAMBRICK AVE	
		163 N ASHLAND AVE	
		195 N ASHLAND AVE	

Form B

Page 1 of 1

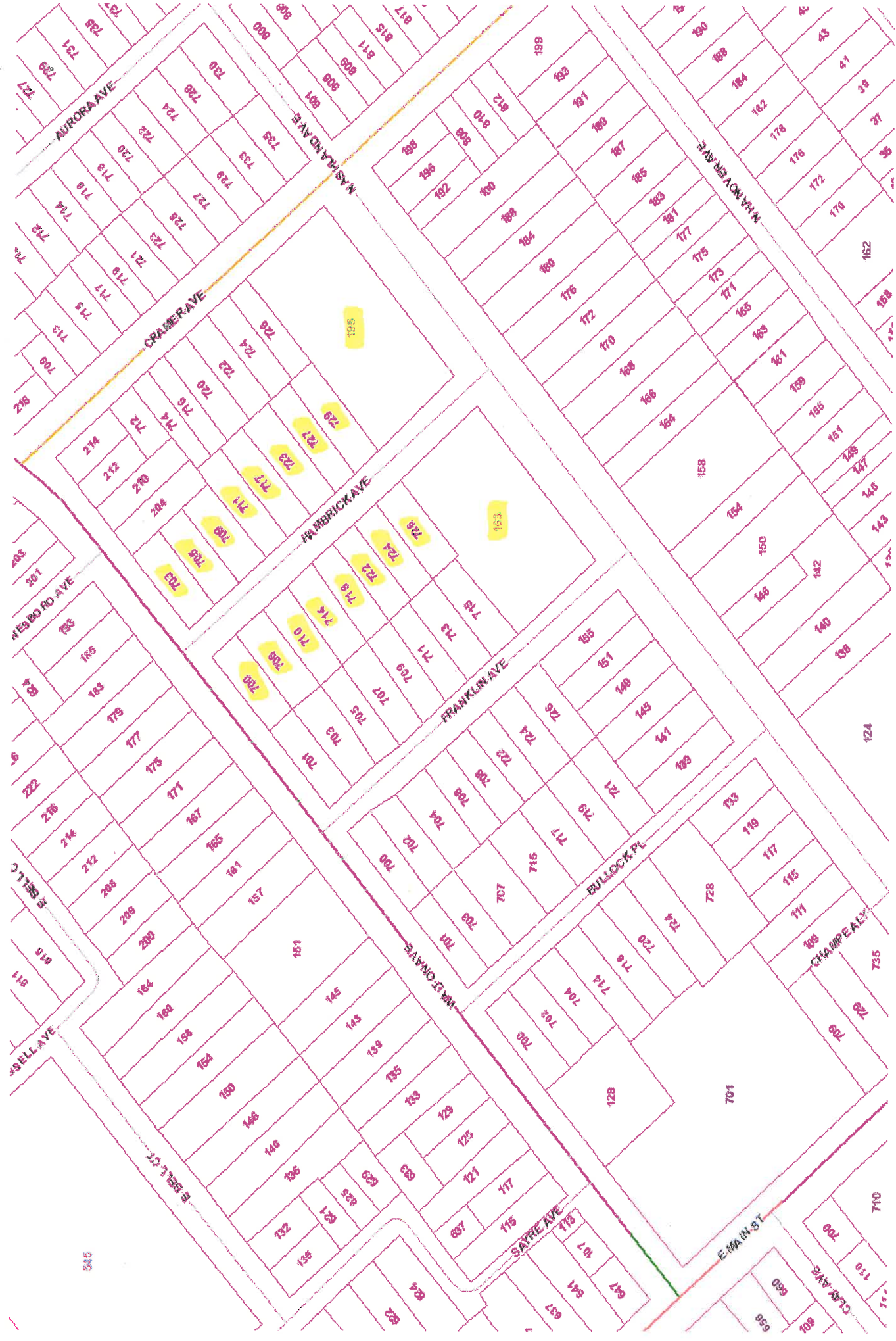

817
815
811
809
808
801
800

737
735
731
728
727

730
728
724
722
720
718
716
714
712
710
708
706
704
702
700

214
212
210
208
206
204
202
200

185
183
181
179
177
175
173
171
169
167
165
163
161
159
157
155
153
151
149
147
145
143
141
139
137
135
133
131
129
127
125
123
121
119
117
115
113
111
109
107
105
103
101
99
97
95
93
91
89
87
85
83
81
79
77
75
73
71
69
67
65
63
61
59
57
55
53
51
49
47
45
43
41
39
37
35
33
31
29
27
25
23
21
19
17
15
13
11
9
7
5
3
1

199
198
197
196
195
194
193
192
191
190
189
188
187
186
185
184
183
182
181
180
179
178
177
176
175
174
173
172
171
170
169
168
167
166
165
164
163
162
161
160
159
158
157
156
155
154
153
152
151
150
149
148
147
146
145
144
143
142
141
140
139
138
137
136
135
134
133
132
131
130
129
128
127
126
125
124
123
122
121
120
119
118
117
116
115
114
113
112
111
110
109
108
107
106
105
104
103
102
101
100
99
98
97
96
95
94
93
92
91
90
89
88
87
86
85
84
83
82
81
80
79
78
77
76
75
74
73
72
71
70
69
68
67
66
65
64
63
62
61
60
59
58
57
56
55
54
53
52
51
50
49
48
47
46
45
44
43
42
41
40
39
38
37
36
35
34
33
32
31
30
29
28
27
26
25
24
23
22
21
20
19
18
17
16
15
14
13
12
11
10
9
8
7
6
5
4
3
2
1

162
161
160
159
158
157
156
155
154
153
152
151
150
149
148
147
146
145
144
143
142
141
140
139
138
137
136
135
134
133
132
131
130
129
128
127
126
125
124
123
122
121
120
119
118
117
116
115
114
113
112
111
110
109
108
107
106
105
104
103
102
101
100
99
98
97
96
95
94
93
92
91
90
89
88
87
86
85
84
83
82
81
80
79
78
77
76
75
74
73
72
71
70
69
68
67
66
65
64
63
62
61
60
59
58
57
56
55
54
53
52
51
50
49
48
47
46
45
44
43
42
41
40
39
38
37
36
35
34
33
32
31
30
29
28
27
26
25
24
23
22
21
20
19
18
17
16
15
14
13
12
11
10
9
8
7
6
5
4
3
2
1

162
161
160
159
158
157
156
155
154
153
152
151
150
149
148
147
146
145
144
143
142
141
140
139
138
137
136
135
134
133
132
131
130
129
128
127
126
125
124
123
122
121
120
119
118
117
116
115
114
113
112
111
110
109
108
107
106
105
104
103
102
101
100
99
98
97
96
95
94
93
92
91
90
89
88
87
86
85
84
83
82
81
80
79
78
77
76
75
74
73
72
71
70
69
68
67
66
65
64
63
62
61
60
59
58
57
56
55
54
53
52
51
50
49
48
47
46
45
44
43
42
41
40
39
38
37
36
35
34
33
32
31
30
29
28
27
26
25
24
23
22
21
20
19
18
17
16
15
14
13
12
11
10
9
8
7
6
5
4
3
2
1

162
161
160
159
158
157
156
155
154
153
152
151
150
149
148
147
146
145
144
143
142
141
140
139
138
137
136
135
134
133
132
131
130
129
128
127
126
125
124
123
122
121
120
119
118
117
116
115
114
113
112
111
110
109
108
107
106
105
104
103
102
101
100
99
98
97
96
95
94
93
92
91
90
89
88
87
86
85
84
83
82
81
80
79
78
77
76
75
74
73
72
71
70
69
68
67
66
65
64
63
62
61
60
59
58
57
56
55
54
53
52
51
50
49
48
47
46
45
44
43
42
41
40
39
38
37
36
35
34
33
32
31
30
29
28
27
26
25
24
23
22
21
20
19
18
17
16
15
14
13
12
11
10
9
8
7
6
5
4
3
2
1

162
161
160
159
158
157
156
155
154
153
152
151
150
149
148
147
146
145
144
143
142
141
140
139
138
137
136
135
134
133
132
131
130
129
128
127
126
125
124
123
122
121
120
119
118
117
116
115
114
113
112
111
110
109
108
107
106
105
104
103
102
101
100
99
98
97
96
95
94
93
92
91
90
89
88
87
86
85
84
83
82
81
80
79
78
77
76
75
74
73
72
71
70
69
68
67
66
65
64
63
62
61
60
59
58
57
56
55
54
53
52
51
50
49
48
47
46
45
44
43
42
41
40
39
38
37
36
35
34
33
32
31
30
29
28
27
26
25
24
23
22
21
20
19
18
17
16
15
14
13
12
11
10
9
8
7
6
5
4
3
2
1

162
161
160
159
158
157
156
155
154
153
152
151
150
149
148
147
146
145
144
143
142
141
140
139
138
137
136
135
134
133
132
131
130
129
128
127
126
125
124
123
122
121
120
119
118
117
116
115
114
113
112
111
110
109
108
107
106
105
104
103
102
101
100
99
98
97
96
95
94
93
92
91
90
89
88
87
86
85
84
83
82
81
80
79
78
77
76
75
74
73
72
71
70
69
68
67
66
65
64
63
62
61
60
59
58
57
56
55
54
53
52
51
50
49
48
47
46
45
44
43
42
41
40
39
38
37
36
35
34
33
32
31
30
29
28
27
26
25
24
23
22
21
20
19
18
17
16
15
14
13
12
11
10
9
8
7
6
5
4
3
2
1